

**TYPICAL SECTION**  
Scale 1:10

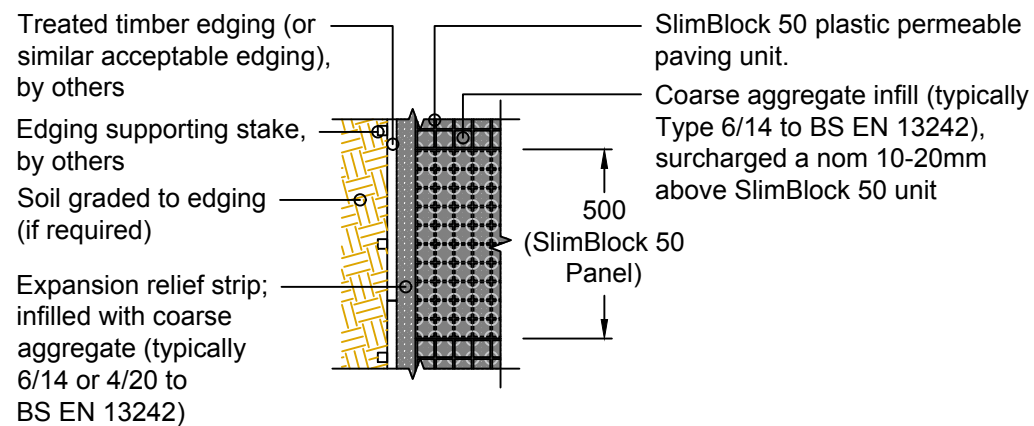

**TYPICAL EXPANSION STRIP DETAIL**  
**PLAN VIEW (AT TOP OF ARBORRAFT FOR CLARITY)**  
Scale 1:20

**NOTES**

1. To be read in conjunction with project specification
2. Typical detail shown. A site specific assessment of the proposed pavement construction should be undertaken by suitably qualified personnel, considering expected vehicle trafficking and underlying ground conditions. Contact Polypipe Civils' technical office for further information.
3. Expansion relief strips should be incorporated at all SlimBlock installation interfaces with pavement kerb/ edging. The expansion relief strip typically taking the form of an aggregate filled band at the kerb and SlimBlock edging interfaces.
4. All dimensions in millimetres, unless otherwise stated.
5. All dimensions are nominal and may vary within manufacturing or construction tolerances.
6. All site temporary and enabling works by others.
7. Polypipe products to be installed in accordance with Polypipe Civils recommendations, giving due consideration to the requirements of the approving organisation(s) and the ultimate owner of the installation.
8. This drawing is intended for guidance only. All proposed installations should be assessed in the context of the site and expected operational conditions, in addition to the overall site drainage scheme, prior to commencement of final design or construction activities.
9. All construction activities shall be executed by competent personnel, in accordance with all relevant legislation, regulations, standards or codes of practice.

REV	AMENDMENT	DATE

All information in this document is of an illustrative nature and is supplied by Polypipe Civils without charge. Polypipe may modify and change the information, products and specifications from time to time for a variety of reasons, without prior notice. Updates will not be issued automatically. This information is not intended to have any legal effect, whether by way of advice, representation or warranty (express or implied). We accept no liability whatsoever (to the extent permitted by law), if you place any reliance on this document you must do so at your own risk. The information within this document should not be solely relied upon to determine the suitability or installation requirements of our products for a proposed application and expected site conditions; expert advice should be sought in this respect.  
Copyright © 2018 Polypipe. All rights reserved. 'Polypipe logo' is a registered trademark of Polypipe. All Polypipe products are protected by Design Right under CDPA 1988.

**Polypipe**  
Polypipe Civils  
North Road, Loughborough  
Leicestershire, LE11 1LE  
Tel: 01509 615100  
Fax: 01509 615215  
www.polypipe.com/civils

PROJECT	POLYPIPE ARBORRAFT TREE ROOT PROTECTION			STATUS FOR INFORMATION		
DRAWING TITLE	ARBORRAFT 85 TRP C/W SLIMBLOCK SURFACE (AGGREGATE INFILL) AND TIMBER EDGING			SHEET SIZE A3	SHEET NO. 1 of 1	DRAWN BY SH
	SCALE As Shown		DATE 12/09/2018			
	DRAWING NO. IG-AR-SD-TRP-85-SBA					REV.